

The 9th Annual Meeting
2018
KOREA GFRAS
Effective Partnership in RAS



global forum for rural advisory services
forum mondial pour le conseil rural
foro global para los servicios de asesoría rural



Rural Development
Administration

9TH GFRAS ANNUAL MEETING

ADDRESSING CHALLENGES AND
SEIZING OPPORTUNITIES:
DEVELOPING EFFECTIVE
PARTNERSHIPS IN RAS

22 – 25 OCTOBER 2018
JEONJU, REPUBLIC OF KOREA

Meeting Organisers

Global Forum for Rural Advisory Services (GFRAS)

c/o AGRIDEA, Jordils 1, CP 1080,
CH-1001 Lausanne, Switzerland
www.g-fras.org
info@g-fras.org

Rural Development Administration (RDA)

300, Nongsaengmyeong-ro,
Wansan-gu, Jeonju-si, Jeollabuk-do
54875, Republic of Korea
[http://www.rda.go.kr/foreign/eng/
rda@korea.kr](http://www.rda.go.kr/foreign/eng/rda@korea.kr)

Asia-Pacific Islands Rural Advisory Services (APIRAS) Network

<https://apiras.net/>
apirasnet2017@gmail.com

Rural Innovation Centre for Knowledge and Investment (RICKI)

jia.xiangping@outlook.com

Venue

Rural Development Administration (RDA)

300, Nongsaengmyeong-ro,
Wansan-gu, Jeonju-si, Jeollabuk-
do 54875, Republic of Korea
www.finihotel.com; (+237) 33 33 26
97

Information Desk

The information desk at the venue
will be manned during breaks for
enquiries for the whole conference.

Contact

Contact GFRAS Secretariat:
annual-meeting@g-fras.org

Annual Meeting website:
<http://g-fras.org/en/am18.html>

Social Media Channels

Follow the meeting on
Twitter and Instagram using the
hashtags #gfras18 and #gfras2018
or on the GFRAS Facebook Group.



Welcome to the 9th GFRAS Annual Meeting!

GFRAS was initiated in 2010 to provide advocacy and leadership on pluralistic and demand-driven extension and rural advisory services (RAS) for sustainable development. It seeks to strengthen RAS by providing a platform for learning and exchange for stakeholders in agricultural innovation systems. This year's Annual Meeting is the ninth edition of the global event and is co-organised with the Rural Develop Administration (RDA), Republic of Korea.

The GFRAS Annual Meeting is a key mechanism for GFRAS to foster learning and exchange and to discuss and strengthen the functioning of GFRAS, its regional networks, and country fora. This year, the meeting will once again provide an opportunity for stakeholders from different sectors, regions, ages, and gender to exchange knowledge, network, and learn from each other.

Since its first edition, the GFRAS Annual Meeting has involved a thematic component, a functional component focused on strengthening the networks, and field trips. This edition also includes a policy roundtable. This year's thematic component focuses on developing partnerships in RAS, for addressing new challenges and seizing new opportunities.

The topic is linked to a widely recognized critical priority in global development across sectors – developing and strengthening effective partnerships and building capacities among different organisations for joint action. The functional component will focus on strengthening the capacities of GFRAS and its regional networks to play an important and meaningful role in developing, strengthening, and maintaining effective partnerships. The field trips will provide an insight into Korea's public agricultural extension services. The policy roundtable explores the roles that the enabling environment plays and identifies structural and policy changes needed in order to foster effective partnerships in RAS.

We are extremely grateful to the Republic of Korea, and RDA in particular, for their hospitality in welcoming the GFRAS Annual Meeting. We also wish to thank the Organising Committee, moderators, GFRAS Steering Committee, and Secretariat for their advice and support throughout the preparatory process. Special thanks are also due to all organising partners (see pages n. 5 & 6) for their highly professional collaboration that has gone towards making this meeting possible. We look forward to a productive and enriching meeting!

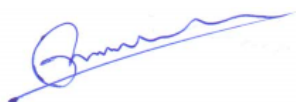

Rasheed Sulaiman V
Chair, GFRAS Steering Committee



Kim, Sang Nam
Director General of Extension Service Bureau
Rural Development Administration (RDA)

Content

This meeting guide is intended to provide basic background information on different meeting components and guide you through the main meeting points. More detailed information can be found on the Annual Meeting website as well as on the GFRAS USB stick provided to you at registration which contains meeting documents and presentations, as well as all GFRAS publications.

Should there be changes in the programme or room allocation, the moderators will inform you of this during the meeting.



Welcome to the 9th GFRAS Annual Meeting	3
Content of the Meeting Guide	4
Local Partners	5
Agenda	7
Side Events, Monday, 22 October	11
Market Place, Monday, 22 October	12
Shift and Share, Tuesday, 23 October	13
Parallel Sessions, Tuesday, 23 October	14
Field Trips, Wednesday, 24 October	16
Reporting & Sharing	17
Meet the Team	18
EcoCycle	20
Floor Plan	21

Local Partners

The 9th GFRAS Annual Meeting could not take place without the invaluable support from local partners. This year, RDA, APIRAS, and RICKI have all contributed towards creating an invaluable learning experience.

RDA



RDA is a Korean governmental organisation that is responsible for agricultural research, rural extension services and international technology cooperation. Through these activities, RDA contributes to sustainable agriculture and enhancing the people's livelihoods.

Korean Agricultural R&D and Extension Services are led by the government. Under the main organisation, RDA, there are 165 local extension centers at city and county levels which facilitate new programs and technologies spread effectively and quickly across the nation. This system has been appreciated as a good extension system model nationwide.

This annual meeting will be a great chance for participants to see and experience Korean RAS and best practices in addition to the great economy development of Korea which was achieved in short time, the beautiful Korean scenery and its culture.

RDA wishes that this annual meeting draws to strengthen networks across regional networks as well as sustainable development in agriculture and rural communities, and would like to express their sincere gratitude to the GFRAS Secretariat, GFRAS Organising Committee and Steering Committee for contributing to organising the 9th GFRAS Annual Meeting.



APIRAS



APIRAS was formally organised during the Regional Forum on Strengthening Rural Advisory Services in the Asia-Pacific Region at the Southeast Asian Regional Center for Graduate Study and Research in Agriculture (SEARCA) in Los Baños, Laguna, Philippines, with Dr. Virginia R. Cardenas chosen as the Regional Network Coordinator.

Its vision is to become an apex organisation of RAS networks, providers, and stakeholders in the Asia-Pacific region, aggregating, synthesizing, and sharing innovations and best practices, through capacity-building, policy advocacy, and knowledge sharing.

With a mission to strengthen institutional collaboration among global, regional, and subregional RAS networks towards responsive capacity development, knowledge management, and policy advocacy in the Asia-Pacific region.

In the long-term, APIRAS hopes to foster a favorable policy environment to achieve food and nutrition security, alleviate rural poverty, enhance community resilience to extreme weather events, social, and economic instability.

RICKI



The Rural Innovation Centre for Knowledge and Investment (RICKI) is a regional network of GFRAS in East Asia. It values effective, demand-driven and sustainable innovation systems in agricultural and rural development.

RICKI conceptualises innovations as a process that needs to be facilitated within an ecosystem that aligns the interests of multiple stakeholders through market mechanisms and investment.

RICKI carries forward the vision of GFRAS in the region and takes actions to strengthen the capacities of rural advisory services so as to effectively contribute to agricultural innovation systems for sustainable development.

The mission is to provide advocacy and leadership on pluralistic and demand-driven rural advisory services for sustainable development. The alliance of RICKI rallies partnerships with public and private stakeholders in China, Korea, Mongolia, and Japan.

Since its inception, RICKI has successfully hosted and jointly organised a number of regional and global events and is becoming an emerging knowledge facility towards its mission and values.

Agenda

MONDAY, 22 OCTOBER

7:00-20:00 Main Building	Registration
9:00-12:30 See page 11 for room allocation	Side events <ul style="list-style-type: none">• APIRAS: Discussion of Capacity Development Plan and Framework for Monitoring, Evaluation, and Learning• CIRAD/RESCAR-AOC/GFRAS with the support of AFD/DLEC: Rural Advisory Services in West and Central Africa: Challenges, Policy Recommendations, and Agenda for the Future• FAO: Exploring the Complex Universe of Agricultural Extension and Advisory Services: Guidelines for Assessing Pluralistic Systems at the National Level• Youth Working Group: Group Launch - Engaging Youth in and for Rural Advisory Services in Agricultural Innovation Systems
12:30-13:30 Cafeteria	Lunch
13:30-17:00	Cultural experience (optional) <ul style="list-style-type: none">• Group 1: Hanok Village• Group 2: Gunsan Saemangeum
17:00-18:00 Main Building	Market place <p>Informal welcome remark by</p> <ul style="list-style-type: none">• Virginia Cardenas, APIRAS <p>See page 12 for the detailed programme</p>
18:00-20:00 Conference Room	Cocktail party <p>Informal welcome remark by</p> <ul style="list-style-type: none">• Lee, Kyu-Seong, RDA Vice-Admin

TUESDAY, 23 OCTOBER

9:00-10:00

Concert Hall

Formal opening

- Rasheed Sulaiman V, GFRAS Steering Committee Chair
- Ra, Seungyong, RDA Administrator
- Song, Ha-jin, Governor of North Jeolla Province

10:00-10:30

Break & group picture session

10:30-11:30

Concert Hall

State of the practice of RAS partnerships: Where are we now? Where are we headed?

Per Video:

- Kristin Davis, Developing Local Extension Capacities (DLEC) Director; Former GFRAS Executive Secretary

Speakers:

- Ernest Edward Bethe III, Principal Operations Officer, International Finance Corporation (IFC), Singapore
- Guy René Faure, Director of the Innovation Research Unit, Centre de Cooperation Internationale en Recherche Agronomique (CIRAD), France
- Jim Leandro Cano, Country Representative, Young Professionals for Agricultural Development (YPARD), Philippines
- Maria Isabel Paredes, Programme Officer, Latin American Network for Rural Extension Services (RELASER), Ecuador
- Mercy Oluwayemisi Akeredolu, Technical Director, Sasakawa Africa Fund for Extension Education (SAFE), Ethiopia

See Ecocycle Handout on Page 20

11:30-12:30

Concert Hall

State of policy in supporting partnerships

Speakers:

- Alpha Sennon, Founder and Executive Director, Whyfarm, Trinidad and Tobago
- David Nielson, GFRAS Steering Committee Co-Chair, USA
- John Peters, Extension and Technical Services Provider, United States Agency for International Development (USAID), USA
- Kinaai Kairo, Director, Ministry of Agriculture, Kiribati
- Mary Wairimu Kamau, Board Chair, African Forum for Agricultural Advisory Services, AFAAS, Kenya
- Yongsup Song, Director General, Agricultural Research and Extension Services Center in North Chungcheong Province, Republic of Korea

See Ecocycle Handout on Page 20

12:30-14:00

Cafeteria

Lunch

<p>13:30-17:30 Auditorium</p>	<p>Korean session</p> <p>Please note this is a parallel event and participation is upon invitation only</p>
<p>14:00-15:00 Conference Room</p>	<p>Shift and share</p> <ul style="list-style-type: none"> • State of RAS/Partnerships from "on the ground" and regional perspectives • Information on Parallel Sessions <p>See page 13 for the detailed programme</p>
<p>15:15-17:00 See page 14 for room allocation</p>	<p>Parallel sessions</p> <ul style="list-style-type: none"> • PS1: Smart Technologies for Effective Partnerships in RAS • PS2: Innovative Financing Towards Effective Partnerships in RAS • PS3: Convergence Through Collaboration and Coordination in RAS
<p>17:00</p>	<p>Buses depart to Grand Hillstone Hotel</p>
<p>17:30-20:00 Grand Hillstone Hotel</p>	<p>Welcome ceremony & dinner</p>

WEDNESDAY, 24 OCTOBER

<p>8:00-8:30 Main Building</p>	<p>Introduction to Korean RAS</p> <ul style="list-style-type: none"> • Mr. Sueng-oh Yoo, Director of Research and Development (R&D) Extension Division, RDA, Republic of Korea
<p>8:40-18:00</p>	<p>Field trips</p> <ul style="list-style-type: none"> • Field Trip 1: Korea's Extension System • Field Trip 2: Value Chain • Field Trip 3: Smart-Farming • Field Trip 4: Rural Youth • Field Trip 5: Farmer's Groups <p>Lunch is planned and will take place near the location of each field trip</p>

THURSDAY, 25 OCTOBER

8:30-10:00 Conference Room	Role of RAS networks in strengthening partnerships: sharing within and between networks See Ecocycle Handout on page 20
10:00-10:30	Break
10:30-12:00 Conference Room	Regional network meetings
12:00-13:30 Cafeteria	Lunch
13:30-15:00 Conference Room	Role of RAS Networks in Partnerships - Where are we going from here?
15:00-15:30	Tea break
15:30-16:30 Conference Room	Bringing it all together: reflections and next steps See Reflection Sheet and Evaluation Form - documents added to the conference bags
16:30-17:00 Conference Room	Closing, reading of the Jeonju Declaration and farewells <ul style="list-style-type: none">• David Nielson, Co-Chair GFRAS, USA• Xiangping Jia, Head of RICKI, China• Lee, Kyu-Seong, RDA Vice Administrator, Republic of Korea
17:30-19:30 Conference Room	Farewell dinner Registration and more information will be available on-spot, during the event <ul style="list-style-type: none">• Mr. Ryu, Gab-hee, President, Foundation of Agri, Tech, Commercialization & Transfer

Side Events

Side events are organised by partner organisations that are present at the GFRAS Annual Meeting and want to profit of the large gathering of members of the RAS community to discuss select topics.

Side events are held on Monday, 22 October and are upon registration only. For more details see the Annual Meeting website.

MONDAY, 22 OCTOBER

08:30-12:30

Seminar Room

APIRAS: Discussion of Capacity Development Plan and Framework for Monitoring, Evaluation, and Learning

This side event aims to work on a capacity development plan for APIRAS, as well as to work on a monitoring, evaluation, and learning framework. On this occasion, the APIRAS Steering Committee meeting will also take place.

08:30-12:30

Conference Room

FAO: Exploring the Complex Universe of Agricultural Extension and Advisory Services: Guidelines for Assessing Pluralistic Systems at the National Level

This event will serve as an occasion to present the first draft of the Assessment Methodologies for Agricultural Extension and Advisory Services System. Upon validation of its draft, FAO hopes to acquire concrete feedback and suggestion in order to improve it, and present to a wider range of stakeholders at its Agricultural Innovation Symposium for Family Farmers.

08:30-12:30

Room #130

CIRAD/RESCAR-AOC/DLEC: Rural Advisory Services in West and Central Africa: Challenges, Policy Recommendations and Agenda for the Future

This event will work towards the identification of ongoing initiatives in the area, and a platform for big actors operating in the region to share their experiences. Potential synergic actions around the main points will be discussed, with the goal to develop an actionable follow-up in the region.

08:30-12:30

Room #112

GFRAS Youth Working Group: Launch - Engaging Youth in and for Rural Advisory Services in Agricultural Innovation Systems

This Working Group that advocates for youth involvement in and for RAS will be formally launched at the 2018 GFRAS Annual Meeting. During this side event, the main goal is to kick start the creation of a knowledge platform for youth in RAS, and discuss: what is the status of youth engagement in RAS in different contexts, the challenges and opportunities for engaging youth in RAS, and success stories to be featured in a knowledge platform to raise awareness on the need for stronger youth engagement in RAS.

Market Place

The Market Place is a tradition at GFRAS Annual Meetings. It offers participants the opportunity to share and peruse information and materials on the latest RAS programmes, distribute important publications, present and exchange new ideas, and get inspired. The market place opens Monday, 22 October, at 17:00, before the official meeting opening and stands will remain available for visitation until Thursday, 25 October. The presenters will be at the stands for questions or discussions on Monday, 22 October, between 17:00-18:00.

MONDAY, 22 OCTOBER

17:00-18:00

Main Building

Agricultural Extension for Agri-startups and Entrepreneurship by the MANAGE Knowledge Innovation and Incubation Centre

Saravanan Raj, Director of Agricultural Extension, National Institute of Agricultural Extension Management (MANAGE)
saravananraj@hotmail.com

ECHO Asia Regional Impact Center

Patrick Trail, Research Coordinator & Agricultural Trainer, ECHO Asia
ptrail@echonet.org

Global Forum for Rural Advisory Services (GFRAS)

Ingrid Oliveira, Communication Officer, GFRAS
ingrid.oliveira@g-fras.org

Korean Extension Specialist Association

Kim, Sakyun, Director of Capacity Building Division, RDA
abc4925@korea.kr

RDA's International Cooperation Program

Kwon, Taek-Ryoun, Director of International Agricultural Group
trkwon@korea.kr

Secretariat of the Pacific Community (SPC) & Pacific Islands Rural Advisory Services (PIRAS)

Gibson Susumu, Participatory Extension Specialist and Acting Team Leader for Sustainable Agriculture Program, SPC & PIRAS
gibsons@spc.int

UF-IFAS Extension Presents Jamaica

Norma Samuel, Extension Agent IV (PhD), University of Florida, Institute of Food and Agricultural Sciences - nsamuel@ufl.edu

Whyfarm

Alpha Sennon, Founder and Executive Director, Whyfarm
alphasennon1@gmail.com

Shift and Share

The Shift and Share offers participants the opportunity to visit presentations of 15 minutes, including time for discussion, on projects and innovative ideas from all around the world. The presentations will be held on Tuesday, 23 October, right after the lunch break.

TUESDAY, 23 OCTOBER

14:00-15:00

Conference Room

Cow dung and earthworms can make you rich and famous

Mahesh Chander, Principal Scientist and Head, Division of Extension Education, ICAR- Indian Veterinary Research Institute
mchanderivri@gmail.com

Creatively empowering youth and kid agripreneurs as global citizens to achieve food and nutrition security by 2050

Alpha Sennon, Founder and Executive Director, Whyfarm
alphasennon1@gmail.com

Development and transformation in agriculture through partnerships; the wool story

Stephanus Terblanche, Senior Lecturer, University of Pretoria, Department of Agricultural Economics
fanie.terblanche@up.ac.za

High quality potato seed production and potato agribusiness in the rural family farming (AFC) organizations in five provinces in the Ecuadorian Highland

Alicia Villavicencio, Project Coordinator, KOPIA Ecuador
alicia.villavicencio@yahoo.com

Project focus productive chains, dialogue for action, and rural extension in Peru - Tumbes case

Bertha Cecilia Garcia Cienfuegos, Titular Researcher, National University of Tumbes
ingcgc@gmail.com

Networking: lessons learned and experiences from a group of RELASER university students

Marisa Gonnella, Miryam Ayala & María Isabel Paredes - Universidad Nacional de Rosario, Universidad Nacional de Formosa, RELASER -
mgonnel@unr.edu.ar

Parallel Sessions

After having set the stage in the plenary sessions in the morning of October 23, the Parallel Sessions will provide participants with the opportunity to have in-depth discussions, and reveal opportunities, challenges, and important next steps for strengthening partnerships in RAS.

This will be done through the lens of three key partnership aspects: Smart Technologies, Innovative Financing, and Collaboration and Coordination.

TUESDAY, 23 OCTOBER

15:15-17:00

Conference Room

Smart technologies for effective partnerships in RAS

Facilitator: Vanh Mixap

Learning tools for farmers organisational development to strengthen partnerships in advisory services

Speaker: Elliot Zwane

PROCAGICA: Strengthened advisory services through improved peer collaboration of extension teams via methodological tools

Speaker: Fernando Barrera Arenas

Smart technologies for enhanced partnerships in RAS: an overview

Speaker: Saravanan Raj

15:15-17:00

Room #112

Innovative financing towards effective partnerships in RAS

Facilitator: Andrea Bohn

Innovative financing of RAS

Speaker: Magdalena Blum

New ways of financing of RAS: reporting back from the RICKI meeting

Speaker: Xiangping Jia

Seizing and scaling Corporate Social Responsibility (CSR) for improving public extension services

Speaker: Mahesh Chander



15:15-17:00

Seminar Room

Convergence through collaboration and coordination in RAS

Facilitator: Nancy White

Agriculture-nutrition interface: addressing the challenges of inter-disciplinary and institutional coordination for improved rural household nutrition in Uganda

Speaker: Margaret Najjingo Mangheni

Collaborating on multi-agency projects - strategies and lessons learned from two community garden projects in South Carolina and Florida

Speaker: Norma Samuel

Collaborating with government agencies to reach a common goal

Speaker: Brian Tairea

Pluralistic service systems - putting lessons learned into practice -Egyptian Model

Speaker: Amira Mahmoud



Field Trips

As you travel out to your field trip, please use the Field Trip Sheet to capture your key insights. You will be sharing them with your peers on Thursday morning (25 October).

8:00-8:30

Conference Room

Briefing: Introduction to Korean RAS

- Mr. Sueng-oh Yoo, Director of Research and Development (R&D) Extension Division, RDA, Republic of Korea

8:40-18:00

Korea's Extension System

The Rural Development Administration (RDA) at the national level, Agricultural Research and Extension Services at the provincial level and Agricultural Extension Center at the city/county level will be visited to learn about how the government leads the research-extension system for dissemination of advanced technology.

Value Chain

This field trip will provide a learning experience on the value chain approach. Places to be visited include an agricultural product processing center, a local food store, a small scaled start-up farm and an educational farm.

Smart-Farming

This field trip includes a visit to smart-farming research and test-bed using ICT in RDA and outstanding smart-farm. Also, the fourth industrial revolution such as ICT application case in farming and development plan of smart-farming will be showcased.

Rural Youth

The training program for fostering rural youth and encouraging them to engage in agriculture will be introduced through this field visit to Korea National College of Agriculture and Fisheries and visit to a successful rural youth's farm producing traditional snacks and breeding livestock.

Farmers' Groups

Visit to the farmer's study group and Korea Extension Specialist's group that are operating self-learning activities for farmer and extension agents. The various studies on income generating model of farmer's group and organizational characteristics will be discussed. Also, the activity of Korean Rural Leaders Central Association, Rural Women Leader's Federation and 4-H and organizational character, project, and role of National Agricultural Cooperative Federation will be introduced.

Reporting & Sharing

Do you want to share the contents of the meeting with colleagues, extensionists, farmers, programme implementers, policy makers, and/or others in the agricultural innovation system in your country or region? Or do you want to make sure your learnings and personal key messages make it back home with you? The following reporting activities, processes, and templates will help you with this during and after the meeting.

During the Meeting

Share impressions of the meeting through **social media channels**:

Twitter #gfras18 or #gfras2018 also on Facebook
(<https://www.facebook.com/groups/gfras/>)

Personal meeting assessments forms:

Keep track of your very personal most important learnings and highlights, contacts you made, websites you want to visit, etc.

Collaborative note-taking: links to shared Google docs will be promoted, where participants can take notes about the different sessions.

The network's little Annual Meeting diary:

Write roadmaps, recommendations, and conclusions in your network's notebook. GFRAS will collect them and keep them safe until the next Annual Meeting.

Exhibitions & Displays

Participants will have a chance to stop by three exhibitions at the RDA, and explore them anytime during the meeting:

- **Outcomes of Agricultural R&D and Extension** will be on display from 22 to 26 October and allow participants the chance to see Smart Farm models.
- The **Agriculture Science Hall** is a reflective place, presenting the past, present, and future of agriculture, its relevance, and latest technologies. This hall contains, among others, a Modern Agriculture Exhibition, a 4D Theater, and The Hall of Fame in Agriculture.

After the Meeting

Find the following documents on the Annual Meeting website after the meeting has concluded:

- The **final agenda** and **final participants list**
- A **short meeting report**, including **key recommendations** for various actors related to RAS
- **Visual reporting** by Nancy White and the facilitation team
- **All opening and closing remarks, presentations, and keynotes** in their original form
- **Video** of selected plenary inputs
- **Detailed summaries** of all sessions and **blogs** from the field trips
- A list, including contact details, **of all share fair stands and side events**
- The **declaration** drafted and agreed upon during the meeting

Meet the Team

While the GFRAS Annual Meeting thrives on the contributions and participation of every person present, a team of people is working behind the scenes to ensure the event runs as smoothly as possible. In case of questions or problems, please don't hesitate to approach one of the friendly resource people below.

Organising Team



Kim, Sang-nam
RDA
Director General of
Extension Service
Bureau



Park, Kyoung-suk
RDA
Director of
Extension Policy
Division



Song, Yong-sup
RDA
Director General of Agricultural
Research and Extension Center
of North Chungcheong Province

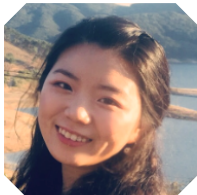

Choi, Eunji
RDA
Organising Team



Choi, Sung-kil
RDA
Organising Team



Jeong, Seong-ok
RDA
Organising Team



Jung, Tae-wook
RDA
Organising Team



Kwon, Chul-hee
RDA
Organising Team



Park, Sun-yong
RDA
Organising Team



Lee, Hyemin
PCO
Organising Team

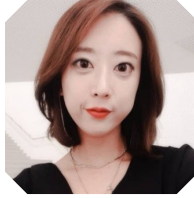

Oh, Jiyeon
PCO
Organising Team



Florian Rudaz
GFRAS Secretariat
Organising Team



Ingrid Oliveira
GFRAS Secretariat
Organising Team



Natalie Ernst
GFRAS Secretariat
Organising Team

Moderators & Facilitators



Andrea Bohn



Nancy White



Vanh Mixap

ECOCYCLE PLANNING

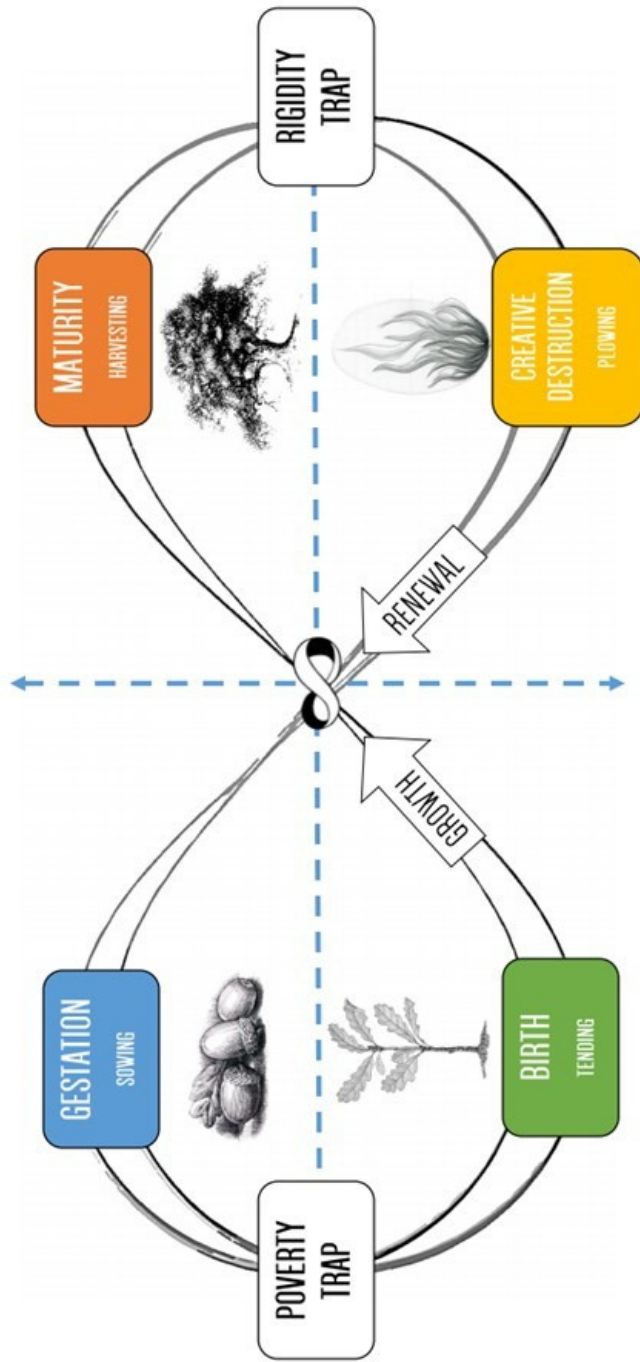

Liberating Structures: Ecocycle Planning
Co-developed by Keith McCandless • Henri Lipmanowicz (www.liberatingstructures.com)
Creative Commons License

Venue: RDA

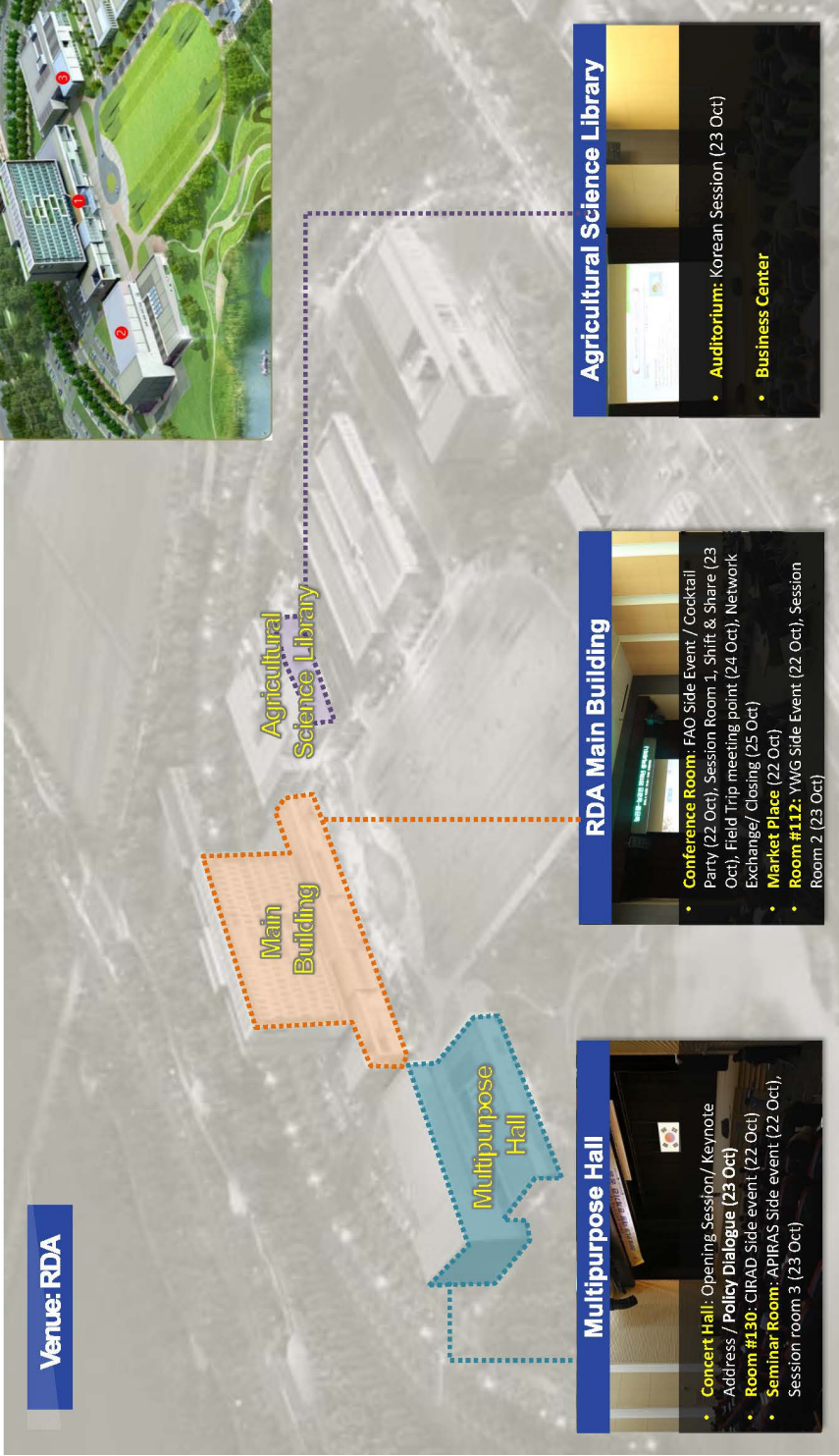

Agricultural Science Library

Agricultural Science Library

- **Auditorium:** Korean Session (23 Oct)
- **Business Center**

Main Building

RDA Main Building

- **Conference Room:** FAO Side Event / Cocktail Party (22 Oct), Session Room 1, Shift & Share (23 Oct), Field Trip meeting point (24 Oct), Network Exchange/ Closing (25 Oct)
- **Market Place** (22 Oct)
- **Room #112:** YWG Side Event (22 Oct), Session Room 2 (23 Oct)

Multipurpose Hall

Multipurpose Hall

- **Concert Hall:** Opening Session/ keynote Address / Policy Dialogue (23 Oct)
- **Room #130:** CIRAD Side event (22 Oct)
- **Seminar Room:** APIRAS Side event (22 Oct), Session room 3 (23 Oct)

Main RDA Building

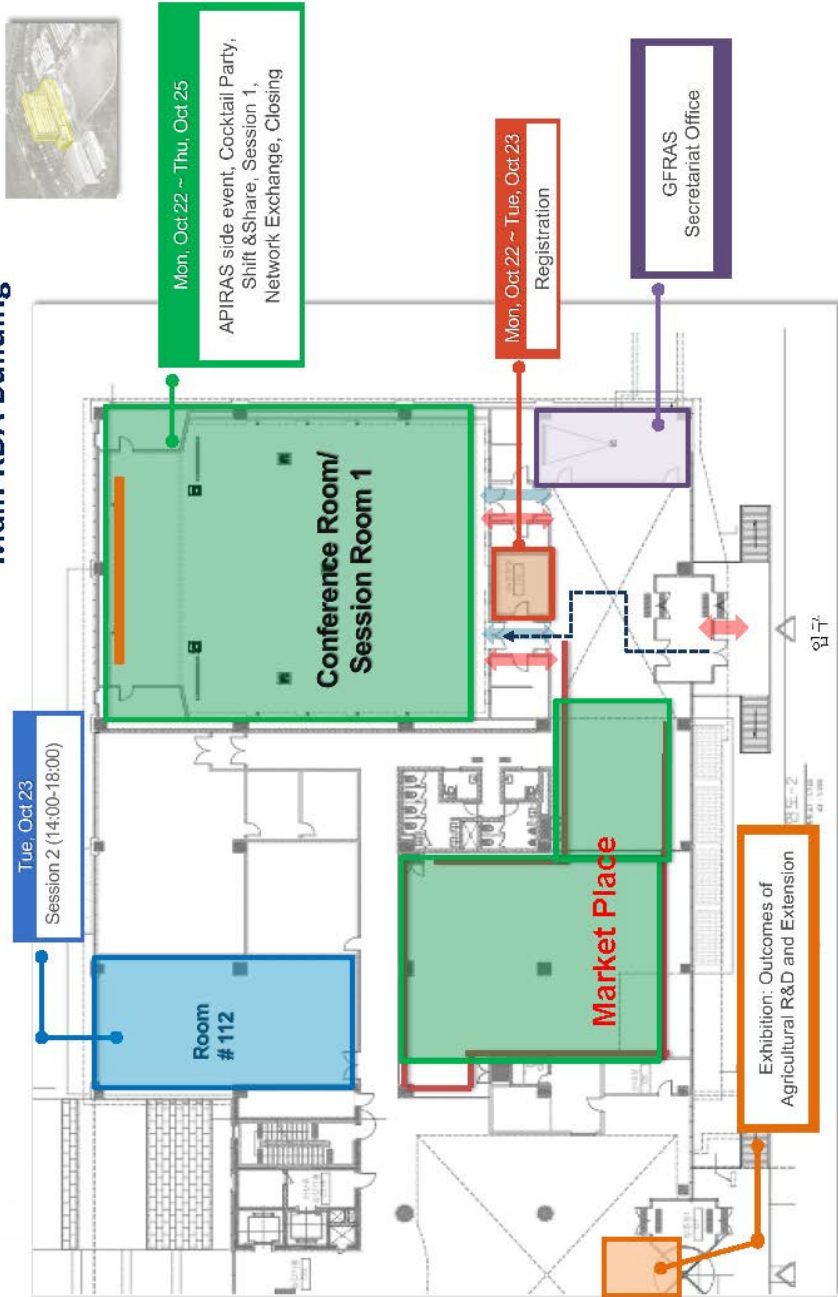

Multipurpose Hall

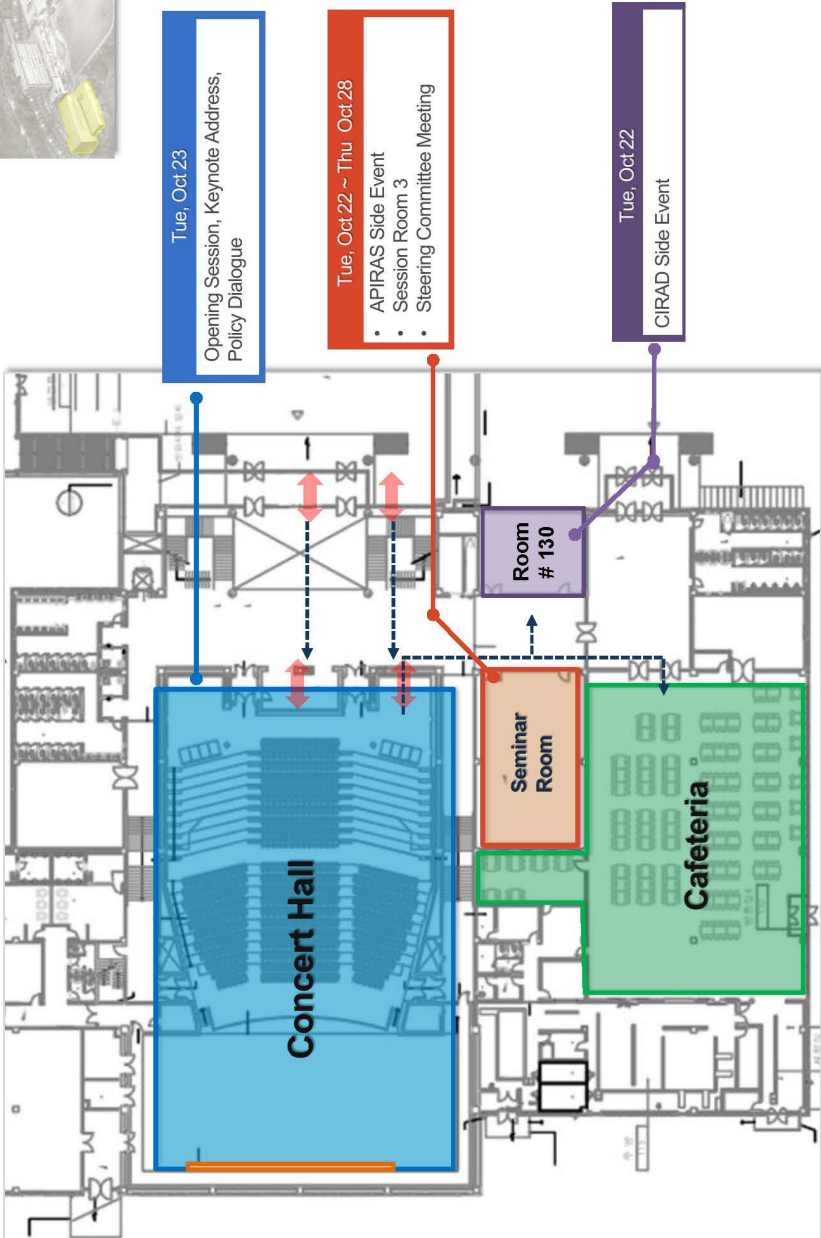

Tue, Oct 23
Opening Session, Keynote Address,
Policy Dialogue

Tue, Oct 22 ~ Thu Oct 28
• APIRAS Side Event
• Session Room 3
• Steering Committee Meeting

Tue, Oct 22
CIRAD Side Event

Agricultural Science Library

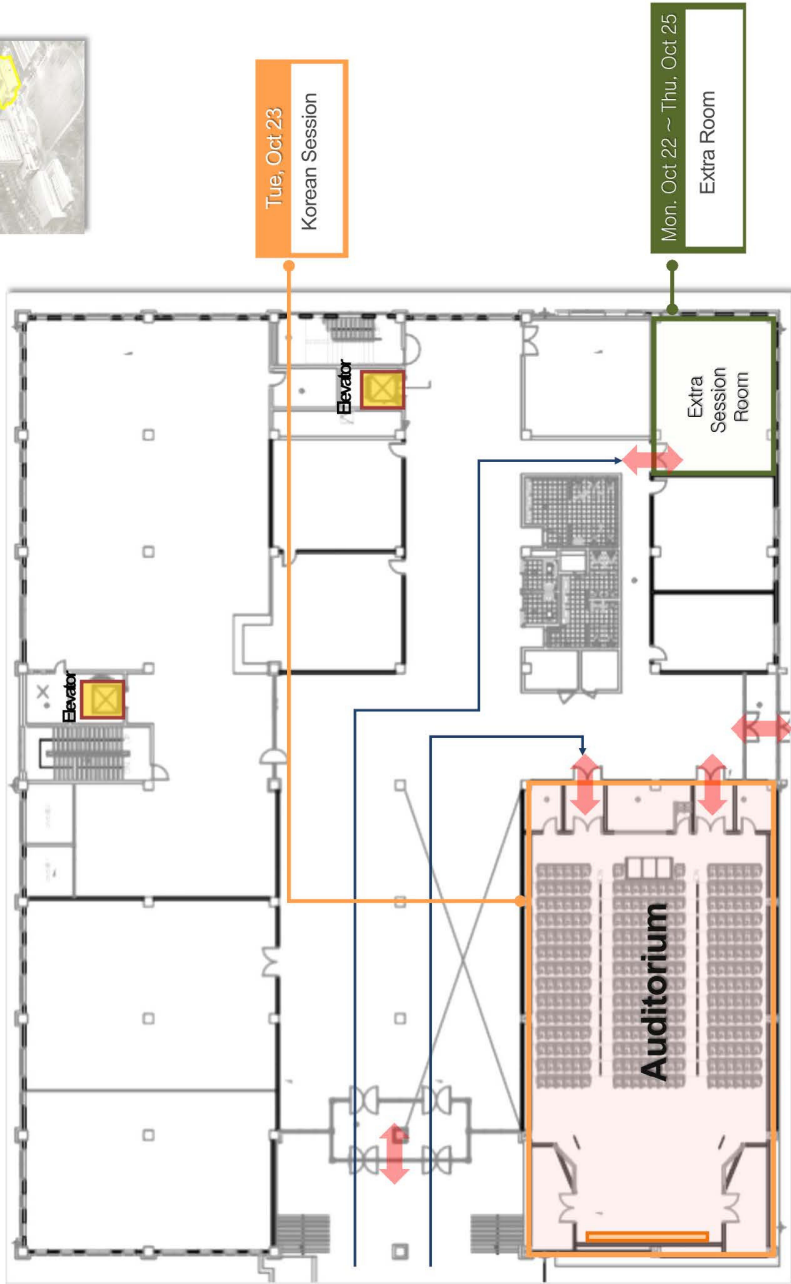

9

Notes

The background of the entire page is a repeating pattern of a green woven fabric texture. The pattern consists of interlocking rectangular shapes that create a mesh-like appearance. The color is a uniform medium green.

Global Forum for Rural Advisory Services GFRAS

c/o AGRIDEA, Jordils 1, CP 1080
CH-1001 Lausanne, Switzerland
www.g-fras.org
info@g-fras.org